



Description & Features:

- Ideal for all applications with vibration and pulsation
- Compact, all stainless steel construction
- Available ranges from low pressure up to 15,000 psi (1,000 Bar)
- Wide range of mechanical and electrical connections
- $\pm 0.5\%$ accuracy
- Fully protected against dust and water, IP65 and IP67
- Built-in restrictor screw to safeguard electronics
- 5 year warranty

Applications:

- Suitable for commercial, industrial and process installations where vibration is prevalent

Specifications	
Output Signal	4...20 mA, 2-wire / $V_s = 12-30$ Vdc 0...10 Vdc, 3-wire / $V_s = 12-30$ Vdc 0...5 Vdc, 3-wire / $V_s = 12-30$ Vdc
Load Consumption	Current Output: $RL \leq (U_s - 12)/20k\Omega$, Voltage Output: $RL > 10$ k Ω
Response Time	1 ms (10%...90%)
Accuracy	$\pm 0.5\%$ Full Scale Output
Long-Term Stability	$\pm 0.02\%$ FSO
Wetted Parts	All stainless steel with 17-4 PH welded sensor
Process Connection	NPT and G connections
Shock	100 g's 11 ms
Vibration	20 g's 20 to 5,000 Hz
Storage Temperature	-40 to 125 deg C (-40 to 257 deg F)
Media Temperature	-40 to 125 deg C (-40 to 257 deg F)
Reverse Polarity Protection	Yes
Electrical Connections	DIN 43650, M12, Packard, Cable Outlet and others on request
Enclosure Rating	DIN 43650 IP65, M12 & Cable Outlet IP67
Operation Life	10 million cycles
Proof and Burst Pressure Ratings	Maximum Working Pressure @ 2X, Burst Pressure @ 5X Full Scale

LMH Hydraulic Transmitter

Dimension (Unit:mm)

DIN43650

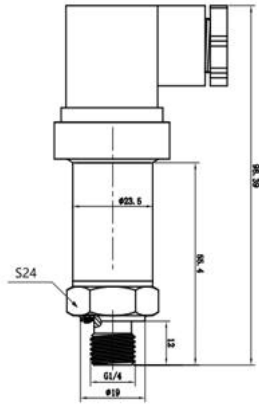

M12*1(4 pin)

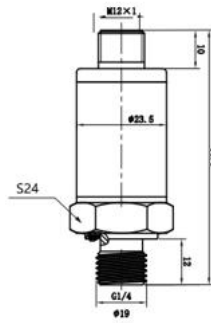

Compact Type (Only 0.5-4.5V Output)

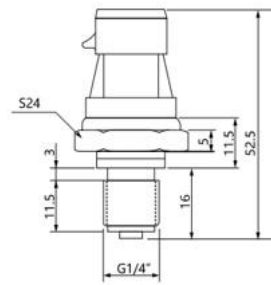

Electrical Connection



DIN 43650



M12*1

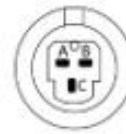

Packard

Terminal	2-wire	3-wire
1	Power "+"	Power "+"
2	Signal	Signal
3		Power "-"

Terminal	2-wire	3-wire
1	Power "+"	Power "+"
2	Signal	Signal
3		
4		Power "-"

Terminal	3-wire
A	Power "-"
B	Power "+"
C	Signal

Process Connection (mm)



1/4" NPT

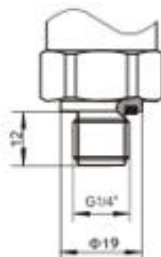

G1/4" DIN3852

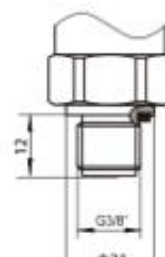

G3/8" DIN3852

Order Codes

Range	Proof Pressure (psi)	4/20 mA 17-4 OG SS, 1/4" NPT Process, 0.5% Acc	
		DIN 43650 C	Cable Outlet (1M/3')
0-150 PSI (0-10 BAR), UL listed	300	LMH1103S5GN47P	LMH1TR3S5GN47P
0-200 PSI (0-15 BAR), UL listed	400	LMH1104S5GN47P	LMH1TR4S5GN47P
0-230 PSI (0-16 BAR), UL listed	460	LMH1105S5GN47P	LMH1TR5S5GN47P
0-300 PSI (0-20 BAR), UL listed	600	LMH1106S5GN47P	LMH1TR6S5GN47P
0-360 PSI (0-25 BAR), UL listed	720	LMH1107S5GN47P	LMH1TR7S5GN47P
0-500 PSI (0-35 BAR), UL listed	1,000	LMH1108S5GN47P	LMH1TR8S5GN47P
0-580 PSI (0-40 BAR), UL listed	1,160	LMH1109S5GN47P	LMH1TR9S5GN47P
0-725 PSI (0-50 BAR), UL listed	1,450	LMH1101T5GN47P	LMH1TR1T5GN47P
0-870 PSI (0-60 BAR), UL listed	1,740	LMH1102T5GN47P	LMH1TR2T5GN47P
0-1,000 PSI (0-70 BAR), UL listed	2,000	LMH1103T5GN47P	LMH1TR3T5GN47P
0-1,500 PSI (0-100 BAR), UL listed	3,000	LMH1104T5GN47P	LMH1TR4T5GN47P
0-2,000 PSI (0-150 BAR), UL listed	4,000	LMH1105T5GN47P	LMH1TR5T5GN47P
0-2300 PSI (0-160 BAR), UL listed	4,600	LMH1106T5GN47P	LMH1TR6T5GN47P
0-3,000 PSI (0-200 BAR), UL listed	6,000	LMH1107T5GN47P	LMH1TR7T5GN47P
0-3600 PSI (0-250 BAR)	7,200	LMH1108T5GN47P	LMH1TR8T5GN47P
0-4000 PSI (0-300 BAR)	8,000	LMH1109T5GN47P	LMH1TR9T5GN47P
0-5,000 PSI (0-350 BAR)	10,000	LMH1101U5GN47P	LMH1TR1U5GN47P
0-6,000 PSI (0-400 BAR)	12,000	LMH1102U5GN47P	LMH1TR2U5GN47P
0-7500 PSI (0-520 BAR)	15,000	LMH1103U5GN47P	LMH1TR3U5GN47P
0-9000 PSI (0-600 BAR)	18,000	LMH1104U5GN47P	LMH1TR4U5GN47P
0-10,000 PSI (0-700 BAR)	20,000	LMH1105U5GN47P	LMH1TR5U5GN47P
0-15,000 PSI (0-1,000 BAR)	30,000	LMH1106U5GN47P	LMH1TR6U5GN47P

Series Number (how to order)

LMH Engineering Codes

OUTPUT	4...20 mA, 2-wire 0...10 Vdc, 3-wire 0...5 Vdc, 3-wire
ELECTRICAL CONNECTION	0.5...4.5 Vdc, 3-wire, ratiometric output Cable Outlet, PVC Shielded & jacketed #24 AWG (1 meter), IP67 M12 circular male connector, IP67 DIN 43650 Type A, IP65 Packard (compact), IP65
SERIES PRESSURE RANGE (PSI)	0-150 PSI (0-10 BAR) 0-200 PSI (0-15 BAR) 0-230 PSI (0-16 BAR) 0-300 PSI (0-20 BAR) 0-360 PSI (0-25 BAR) 0-500 PSI (0-35 BAR) 0-580 PSI (0-40 BAR) 0-725 PSI (0-50 BAR) 0-870 PSI (0-60 BAR) 0-1,000 PSI (0-70 BAR) 0-1,500 PSI (0-100 BAR) 0-2,000 PSI (0-150 BAR) 0-2300 PSI (0-160 BAR) 0-3,000 PSI (0-200 BAR) 0-3600 PSI (0-250 BAR) 0-4000 PSI (0-300 BAR) 0-5,000 PSI (0-350 BAR) 0-6,000 PSI (0-400 BAR) 0-7500 PSI (0-520 BAR) 0-9000 PSI (0-600 BAR) 0-10,000 PSI (0-700 BAR) 0-15,000 PSI (0-1,000 BAR)
ACCURACY	0.5% Gauge pressure
PROCESS CONNECTION	1/4" NPT male 1/2" NPT male G 1/4" male G 1/2" male
SEAL	17-4 PH Stainless Steel all welded 316L Stainless Steel all welded
SPECIAL	PSI pressure range (standard scale, do not need to include in p/n) BAR pressure range Additional 6 ft (2m) PVC cable Additional 10 ft (3m) PVC cable Additional 15 ft (4.5m) PVC cable Special

